



Matrix® C-Channel Frame Kit

For Lattices & Screens | INSTALLATION INSTRUCTIONS

Jack Matrix C-Channel Frame Kit is designed to be used with Jack Matrix Lattices and Screens. It allows you to attach the panel between or in front of vertical or horizontal supports, or to the inside of a frame. The Jack Matrix C-Channel Kit makes installation of Jack Matrix Lattice and Screen Panels easy, attractive and secure, while allowing the panel to expand and contract with changes in temperature.

Kit Contents

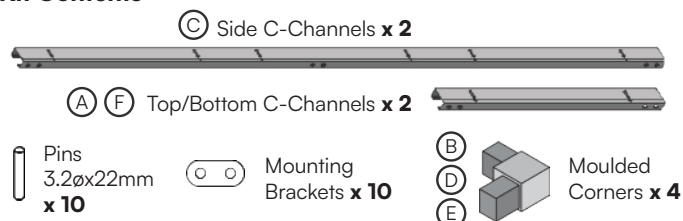

	Side Length (mm)	Top/Bottom Length (mm)
2412 Kit Assembled Size 2425 x 1218mm	2385	1178
1812 Kit Assembled Size 1808 x 1218mm	1768	1178
1809 Kit Assembled Size 1808 x 912mm	1768	872

Assembly Overview

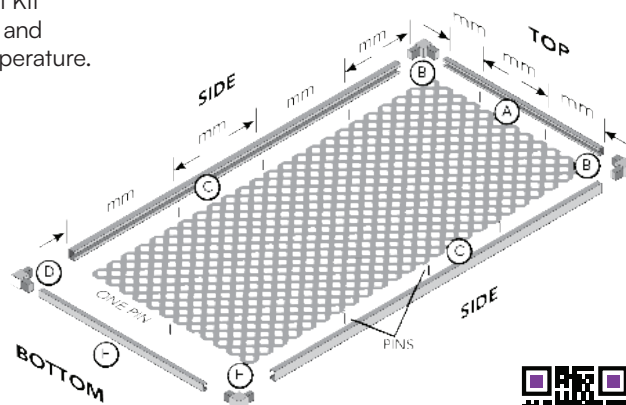

Tools and hardware recommended

- Spirit Level
- Rubber Mallet
- Tape Measure
- Pliers
- Steel Saw
- Jigsaw
- Drill with a 3mm drill bit
- Screws or bolts for attachment

Quick Start Guide

Step 1: Drill and fix pins

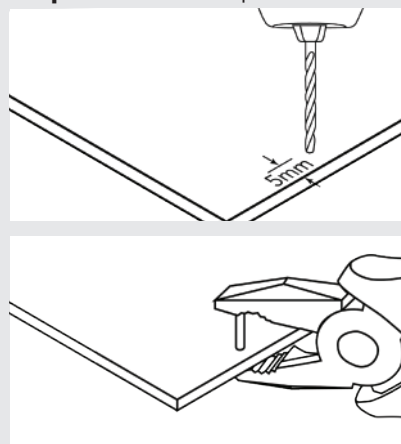

Step 2: Slide channels into place

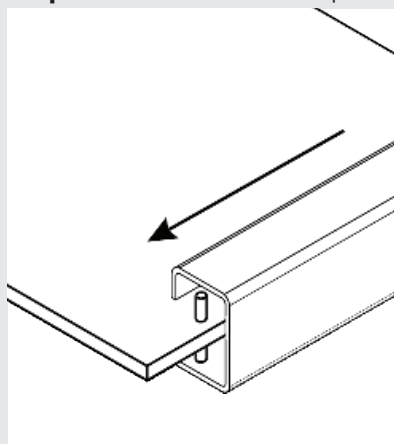

Step 3: Insert corners

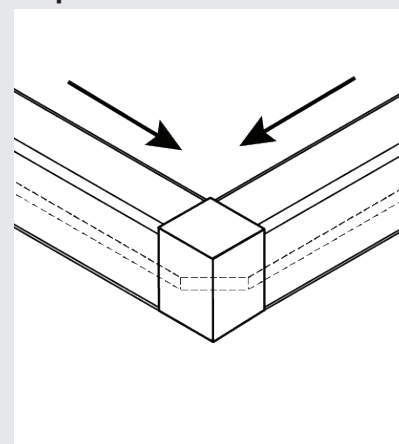

Panel Dimensions

Some expansion and contraction of the lattice/screen will occur with changes in temperature (see table on right). Attaching Jack Matrix screening products with no provision for thermal expansion and contraction will void the warranty. Figures shown are an approximation only of variation due to temperature fluctuations.

	2412 Kit	1812 Kit	1809 Kit
At 0°C	2400 x 1200mm	1794 x 1201mm	1794 x 897mm
At 20°C	2410 x 1205mm	1800 x 1205mm	1800 x 900mm
At 40°C	2420 x 1210mm	1806 x 1209mm	1806 x 903mm

15 Year Manufacturer's Warranty

Whites Group warrants to the original purchaser that Jack Matrix screening products will be free of structural faults due to defects in manufacturing for a period not exceeding 15 years from the date of purchase. Whilst the colour formulation has been designed to withstand many years of exposure to the sun and weather, the warranty does not cover natural fading or a reduction of material properties over time. This warranty is only valid where the product has been installed according to the manufacturer's installation instructions. All warranty matters are to be referred through the original place of purchase. Valid warranty claims will be settled by either full replacement or satisfactory repair of the product. Warranties and remedies including compensation for consequential or direct losses, other than those set out above are hereby excluded, except to the extent where to so exclude would contravene any law including the Trade Practices Act (Cth. 1974) or cause any part of this warranty to be void.

Jack Matrix C-Channel Frame Kit

For Lattices & Screens



INSTALLATION INSTRUCTIONS

1. Prepare the Panel and Frame Components

- This kit is designed to fit a standard full sheet of lattice or screen panel 2410 x 1205mm. The use of recycled materials, some variation in panel size may occur. If adjustment is necessary, cut down the channels so that they are 25mm shorter than the panel dimensions.
- If you need to reduce the height and/or width, cut the C-channels with a steel saw first, then trim the panel using a jigsaw by the same amount.
- Use three pins (evenly spaced 300-600mm apart) on each long side and two pins (spaced 400mm apart) on the top short side. Only place one pin in the centre on the bottom edge (**Fig. 1**)

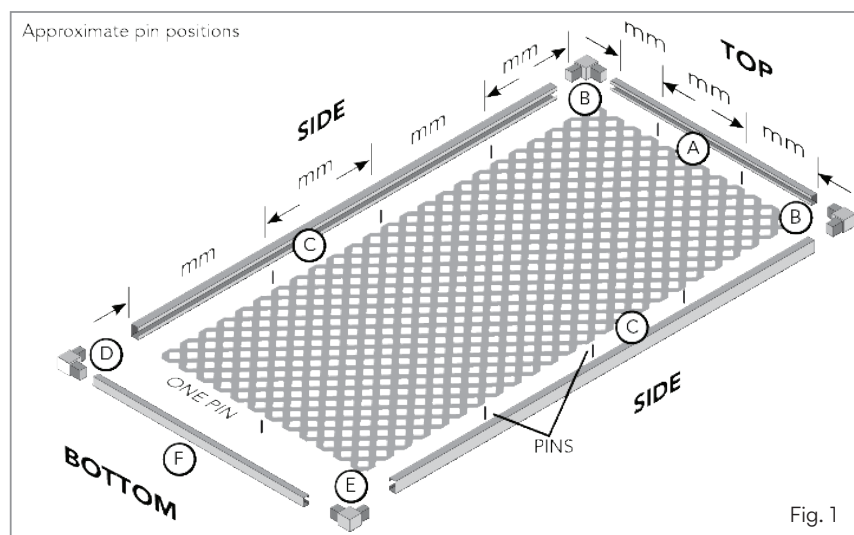

Fig. 1

- Drill 3mm holes 5mm from the edge of the panel (**Fig. 2**)

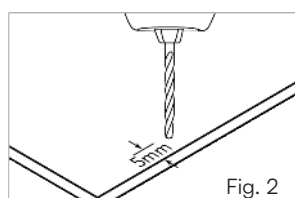

Fig. 2

Drill 3mm hole, 5mm from edge using template above

- Using pliers insert the pins supplied in the kit into the holes (**Fig. 3**)

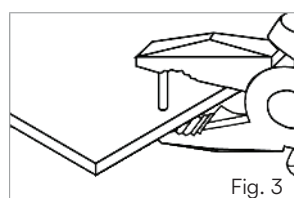

Fig. 3

Insert pins into panel

- Cut off corners and notch edges as required to create clearance for screws (**Fig. 4, 5**). This is not required if the screws can be positioned in the gaps of the lattice.

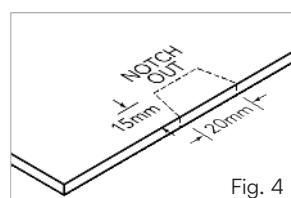

Fig. 4

Cut away 15 x 20mm from screen edge if attaching through C-channel as in Fig. 8 & 10

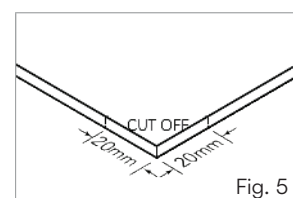

Fig. 5

Cut off 20 x 20mm from screen corner if attaching through plastic corners as in Fig. 7

2. Assemble the C-Channel Kit (see Fig.1)

- Slide top C-channel over the pins (**Fig. 6**) onto the top edge of the panel.
- Insert a moulded corner into each end of the top C-Channel and tap in gently.
- Slide the two side C-channels along the edges of the panel over the pins and gently tap into place.
- Insert a corner into one of the free ends of the long (side) C-channel and gently tap into place.
- Insert the last corner into the remaining short (bottom) C-channel and gently tap into place.
- Slide bottom C-channel over the pin on the bottom edge of the panel and gently tap into place. Flex the C-channel on the long sides to align the last corner with the bottom and side and complete the assembly.

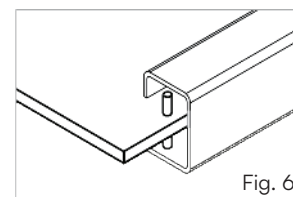

Fig. 6

Slide C-channel over pins

3. Attach the Framed Panel

- Use the 10 supplied flat brackets to secure the frame to your support structure. Ensure brackets are positioned in areas to coincide with the panel notches (**Fig. 7**).
- Attach the flat brackets to the C-Channel using screws or rivets ensuring that the screws are offset from the centre of the C-Channel (**Fig. 8**) so that they do not interfere with the thermal expansion of the panel. Position the brackets so they don't interfere with the pins.
- We recommend using three brackets on each long side and two brackets on the short side (**Fig. 1**).
- Attach the other end of each bracket to the support structure using appropriate screws.
- Alternatively, drill holes straight through the corners and/or C-channels and attach directly to the support structure using screws 50mm or longer (**Fig. 9, 10**).

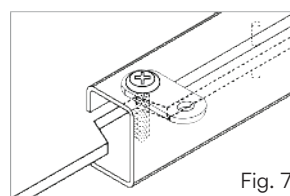

Fig. 7

Cut away screen to prevent interference with screws

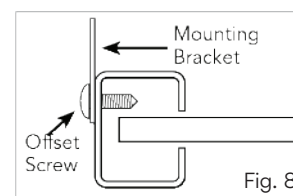

Fig. 8

Offset screws so that they do not interfere with the panel

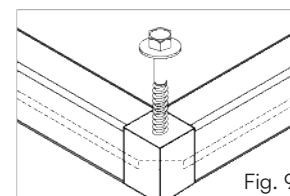

Fig. 9

Attaching through plastic corners

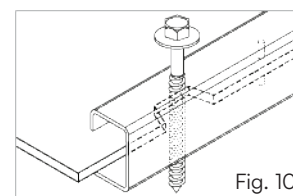

Fig. 10

Attaching through C-Channel